

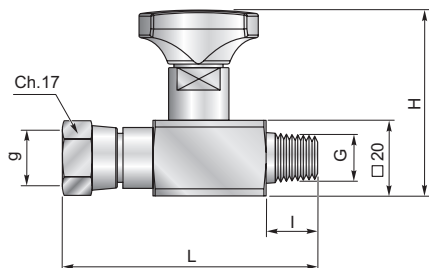

**Esclusore attacco diritto girevole**

*Anti-shock valve swivel straight connection*



G	g	H	L	I	PN [bar]	Codice/Ref.
ISO 7/1 R 1/4"	ISO 228 G1/4"	50	60	14	400	ES 180

**Esclusore attacco diritto doppia femmina girevole**

*Anti-shock valve double swivel straight connection*

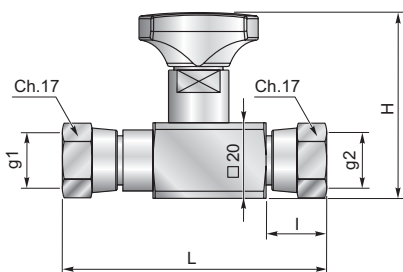

g1	g2	H	L	I	PN [bar]	Codice/Ref.
ISO 228 G1/4"	ISO 228 G1/4"	50	60	14	400	ES 18G

**Esclusore attacco diritto fisso**

*Anti-shock valve fixed straight connection*

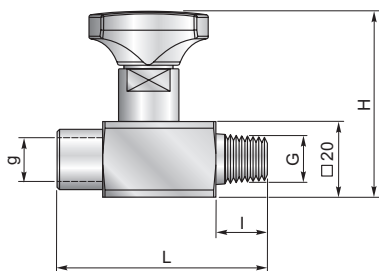

G	g	H	L	I	PN [bar]	Codice/Ref.
ISO 7/1 R 1/4"	ISO 228 G1/4"	50	58	14	400	ES 18F
ISO 7/1 R 1/4"	ISO 7/1 R 1/4"	50	58.5	14	400	ES 18FR



**Esclusore attacco 90°**

*Anti-shock valve 90° connection*

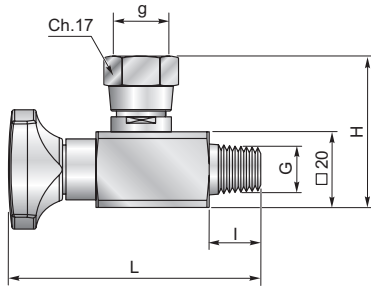

G	g	H	L	I	PN [bar]	Codice/Ref.
ISO 7/1 R 1/4"	ISO 228 G1/4"	40	68	14	400	ES 090

**Esclusore attacco 90° doppia femmina girevole**

*Anti-shock valve 90° double swivel connection*

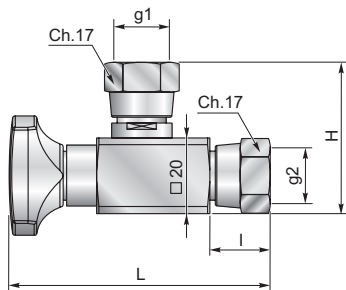

g1	g2	H	L	I	PN [bar]	Codice/Ref.
ISO 228 G1/4"	ISO 228 G1/4"	40	68	14	400	ES 09G

**Esclusore attacco fisso 90°**

*Anti-shock valve fixed 90° connection*

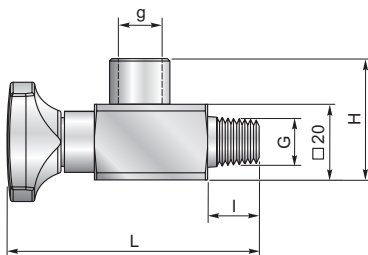

G	g	H	L	I	PN [bar]	Codice/Ref.
ISO 7/1 R 1/4"	ISO 228 G1/4"	40	68	14	400	ES 09F